

TUTTE LE OPERAZIONI DEVONO ESSERE EFFETTUATE DA PERSONALE SPECIALIZZATO

ALL OPERATIONS MUST BE CARRIED OUT BY QUALIFIED PERSON - TOUS LES OPERATIONS DOIVENT ETRE EFFECTUEES PAR DES PROFESSIONNELLES

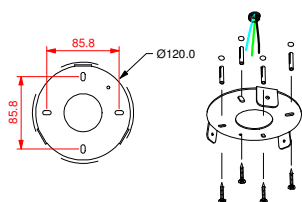

1.
Fix the bracket to the ceiling. (use appropriate anchors depending on the type of wall)

Fissare la staffa al soffitto. (utilizzare tasselli appropriati in relazione al tipo di soffitto)

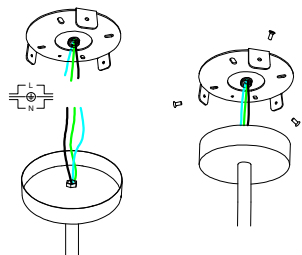

2.
Connect the lamp to the main power, then fix the canopy on the bracket with the screws supplied.

Connettere la lampada all'impianto elettrico, quindi fissare il rosone alla staffa utilizzando le viti fornite.

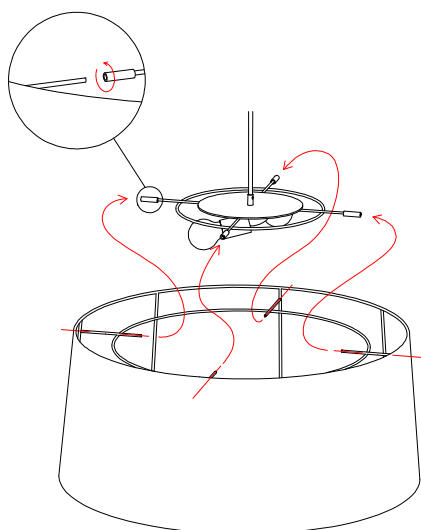

3.
Place the shade pivots aligned with the central cross and unscrew the four cylindrical nuts.

Posizionare i perni del paralume allineati alla croce centrale e svitare i quattro dadi cilindrici.

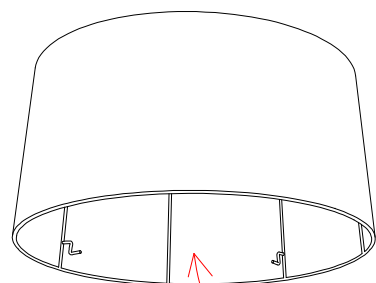
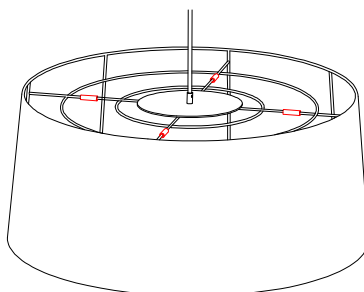

4.
Insert the diffuser disk from the bottom of the shade and lay it down on the frame pivots.

Inserire il disco diffusore dal basso del paralume e appoggiarlo sui ganci del telaio.

