

## ISTRUZIONI INSTALLAZIONE - INSTALLING INSTRUCTIONS - INSTRUCTIONS DE MONTAGE

CAUTION : BEFORE STARTING, TURN OFF POWER OF MAIN CIRCUIT PANEL

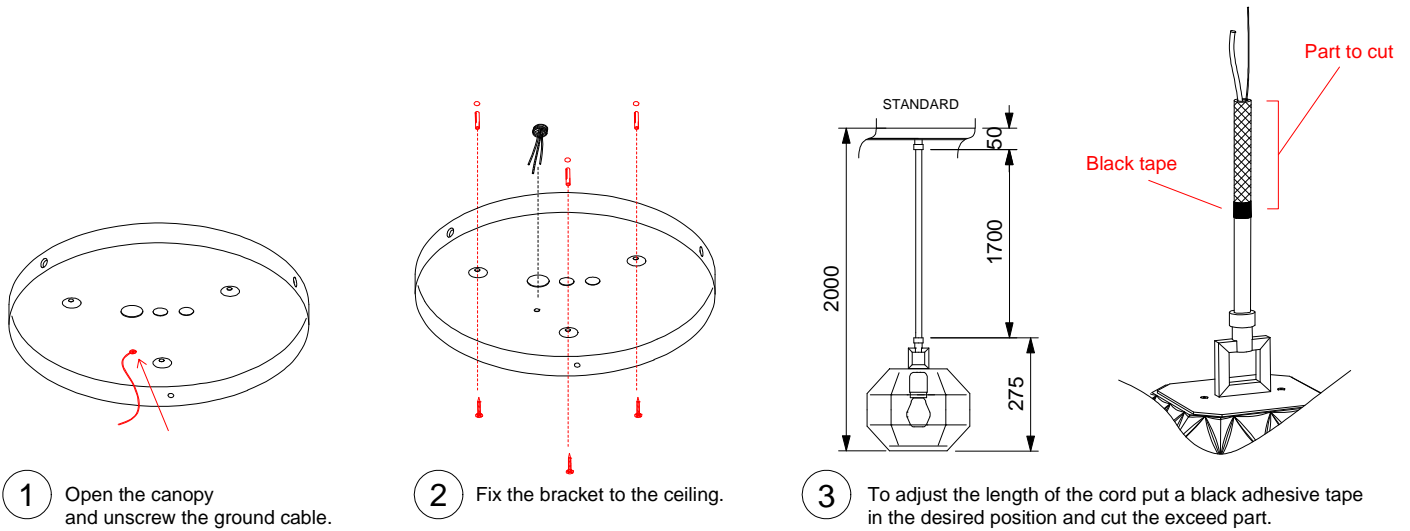

**PAY ATTENTION:**  
DON'T CUT THE CURRENT CABLE  
AND THE STEEL SECURE CABLE INSIDE!

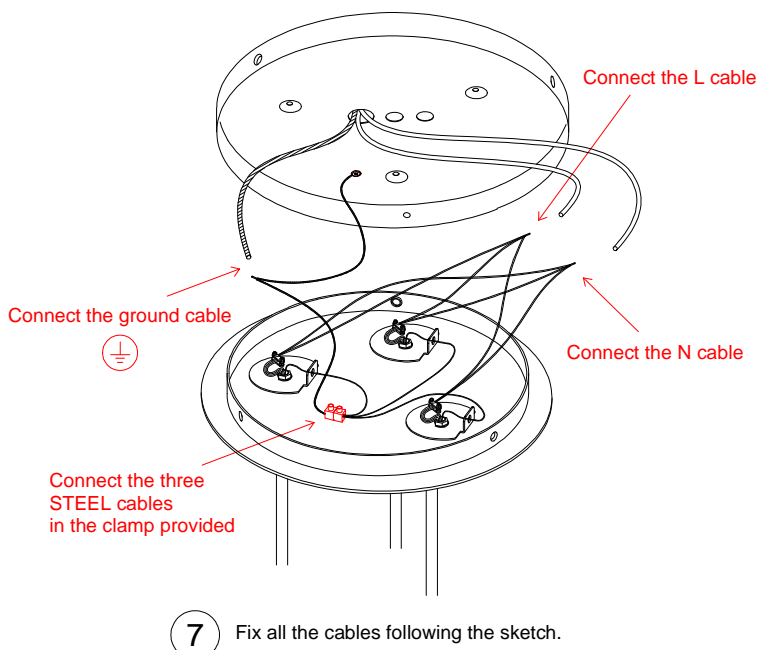
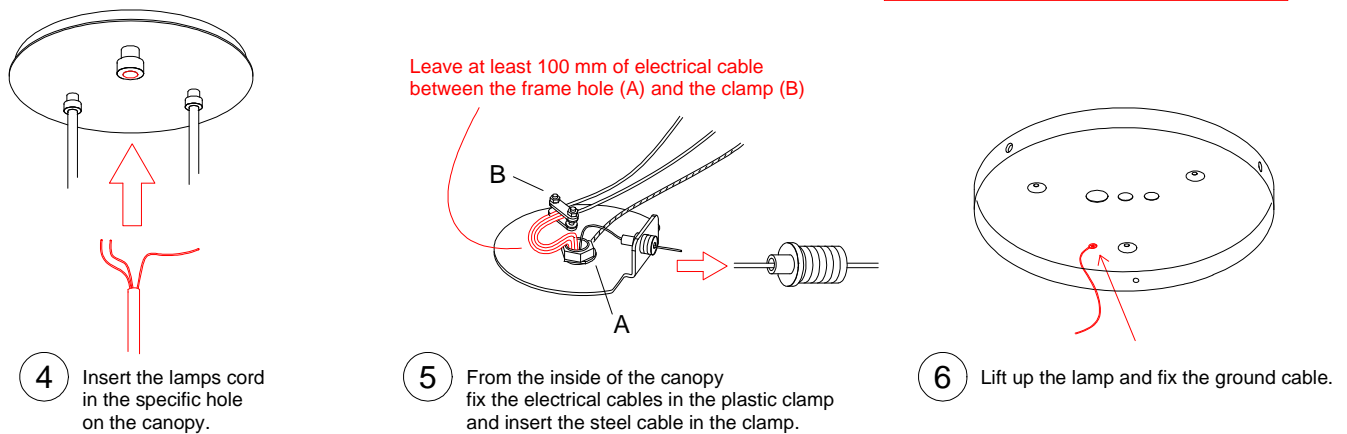

**8** Fasten the lamp to the bracket with the screws provided.

